



**BLUE LOGIC**

### 001 LOW WEIGHT

Submerged weight only 11 kg.  
Plug and Play, just add PC and electrical power.

### 003 FLEXIBLE

Perfect for both subsea operations and topside testing/operation. Easy handling and no cooling required during topside running.

## API17H CL1-4 LIGHT WEIGHT ELECTRICAL TORQUE TOOL

All-electric, ultra light multipurpose torque tool with auto socket. Ideal for UID/AUV's, ROV's and divers.

### 006 POSITION ACCURACY

Output key position accuracy better than 1° with GoTo position functionality. Topside and subsea torque verification jigs available.



### 002 FLEXIBLE POWER INPUT

400VDC input for standard version. External Power Supply available to adapt to any power supply available from the host. 48V versions available upon request.

### 004 ADAPTIVE CONTROL SYSTEM

GUI for operation via laptop/PC. Large range of settings and auto-functions. Logging of all parameters for full operational documentation. Integration with 3<sup>rd</sup> part control systems feasible.

### 005 SMOOTH OPERATION

Precise motor controller enables gentle operation. Ramp-up and ramp-down feature ensures careful operation of critical applications.

### 007 AUTO CLASS SELECT

Spring-activated multi-socket for automatic adaption to suit all classes 1 -4.



BLUE LOGIC

# BLUE LOGIC CL1-4 LIGHT WEIGHT ELECTRICAL TORQUE TOOLS

The Blue Logic Light Weight Torque Tool, LWETT, uses a modern servo-based electrical controlled drive system in combination with a custom-built titanium gearbox with polymeric housing resulting in the world's lightest and most compact subsea torque tool.

Torque and position control is well suited for condition monitoring of valves and precise torquing of bolted connections.

Rotation speed, angular position and torque output are precisely controlled, monitored and logged. Performance and accuracy not influenced by ambient temperature in either static or dynamic operations.

If DC power is not available, the compact and efficient power supply with power factor controller is a perfect option. Dedicated Graphical User Interface included.

Integration into existing control systems is easily performed using the standard Modbus communication interface.

A variety of additional components and features available:

- Torque verification jigs, both topside and subsea versions
- Inductive connector for subsea connect/disconnect
- AC-DC Power Supply (Power Factor Controller)
- Class 4-7 gearbox (torque multiplier)
- Diver handle
- ROV handle

## Technical Data for Torque Tool Kit BC0985

Article No.	BC0985
Depth rating	500m
Supply Voltage	400VDC
Standards	API17H/ISO 13628-8, API 17D
Output sockets	API17H/ISO 13628-8 Class 1 - 4
Weight in air	23,0kg
Weight in seawater	11,5kg
Torque range, Cl1-2	100 – 300Nm
Torque range, Cl3-4	300 – 2700Nm
Max speed, low torque	6 RPM
Max speed, 2700Nm	6 RPM
Torque accuracy	+/-10%
Positioning precision	+/- 1 °
Max. power consumption	2000W
Min/Max current draw <sup>1</sup>	5A / 13,5A
Communication	RS232 or RS485, Modbus RTU Protocol
Electrical Interface	Subconn BCR2010M

1)Max. current draw can be set in GUI to suit ROVs with limited power output.

Technical data subject to change due to continuous development/improvement.

The Light Weight Torque Tool are also available in 3000m versions and/or 48VDC. Please contact Blue Logic for available configurations.



BA7719 AC/DC Power Supply



BB2985 TT Control PC



BB2408 Cl. 6 / 7 Gearbox



101202 Cl.4 Calibration Jig

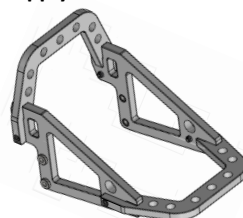

BB3676 Diver Handle



BB3557 ROV Handle



BB7009 Cable Kit



BB0167 Cl.2 Calibration Jig